

designwerk

Jive

Dynamic. Vibrant. Practical. Thanks to elaborate, carefully considered modular elements and new types of cushions, Jive can be individually configured to ensure that all needs are completely fulfilled. Special consideration was placed on the flexible back and arm sections, which can be freely placed and arranged as your heart desires. Does the cheeky look of Jive make you want to shake your hips?



Model: Jive ELT 180 + ELT 100 + ELT 180

Cover: Fabric Jolie G066 Beige, Fabric Roma E161 Vanilla Ice

JIVE

Details





Model: Jive 2x element 180 + 2x element 100
Cover: Fabric Roma E161 Vanilla Ice, fabric Jolie G066 Beige

vibrant.



JIVE Types

Foot available in:



B: black mat

Please specify foot variant on order.

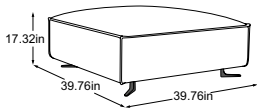

Element 100

Item number: D028100

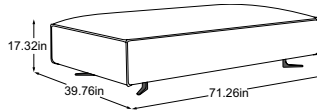

Element 180

Item number: D028180

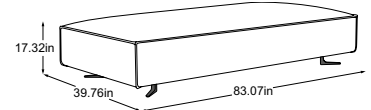

Element 210

Item number: D028210

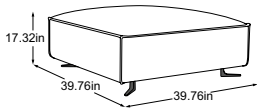

Element 100 (Jive II)

Item number: D094100

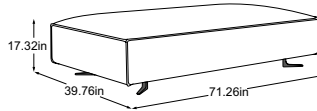

Element 180 (Jive II)

Item number: D094180

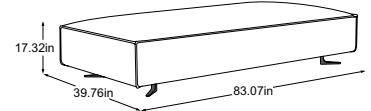

Element 210 (Jive II)

Item number: D094210

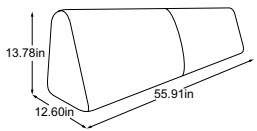

Double pyramid cushion

Item number: D028953

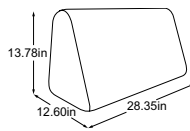

Pyramid cushion

Item number: D028952

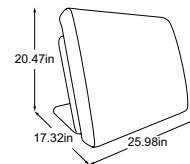

Comfort cushion

Item number: D028951

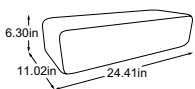

Block arm part

Item number: D028981

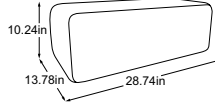

Block back cushion

Item number: D028950

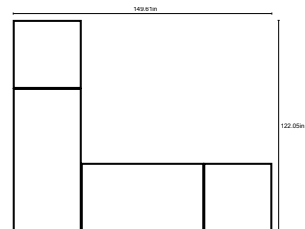

**2x element 100 - element 180 -
element 210**

Item number: D028230



Foot available in:



B: black mat

Please specify foot variant on order.

JIVE

Combinations

1 article number – countless combinations

Jive consists of various individual elements that can be combined in multiple ways. There are virtually no limits to your imagination! Thanks to our new 'easyjack' connector system, the individual elements can be easily rearranged at any time without tools or assistance.

Here are a few combination recommendations:

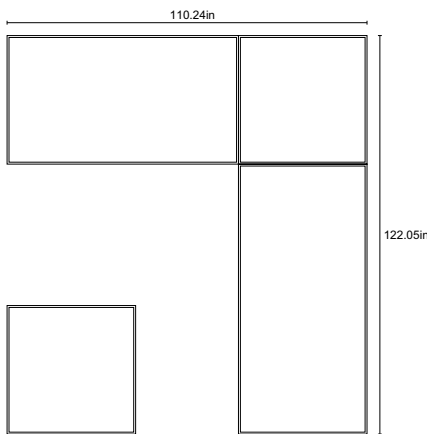

**2x element 100 - element 180 - element 210
(version 1)**

Item number: D028230

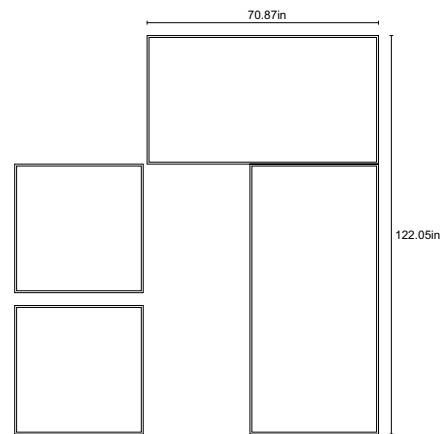

**2x element 100 - element 180 - element 210
(version 2)**

Item number: D028230

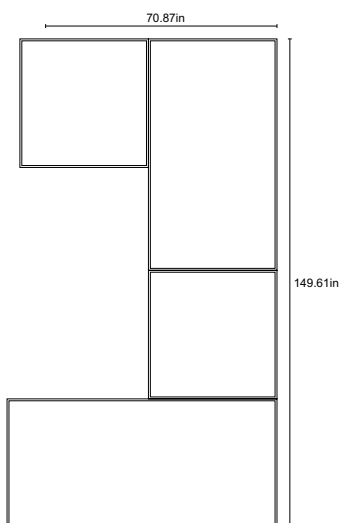

**2x element 100 - element 180 - element 210
(version 3)**

Item number: D028230

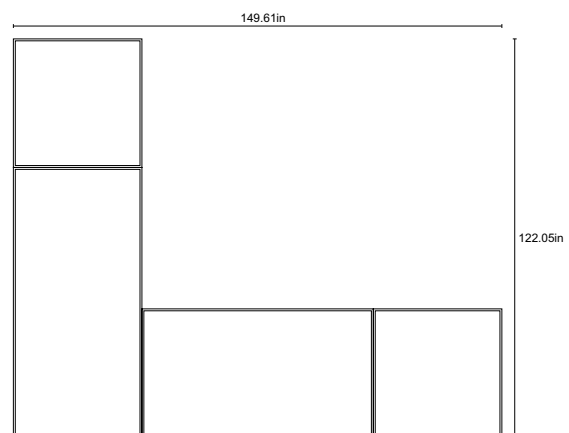

**2x element 100 - element 180 - element 210
(version 4)**

Item number: D028230